



BEE VALVE INC.



Push-In Tube Fittings

Features

- FDA / NSF compliant
- Quick and easy to use and re-use
- Resists inorganic chemicals, oils, fats, and synthetic detergents

[Adapter, Female NPTF Thread](#)
[Connector, Male NPTF Thread](#)
[Connector, Straight](#)
[Elbow, Male NPTF Thread](#)
[Elbow, Male Swivel NPTF Thread](#)
[Elbow Union](#)
[Union Connector](#)
[Union Tee](#)

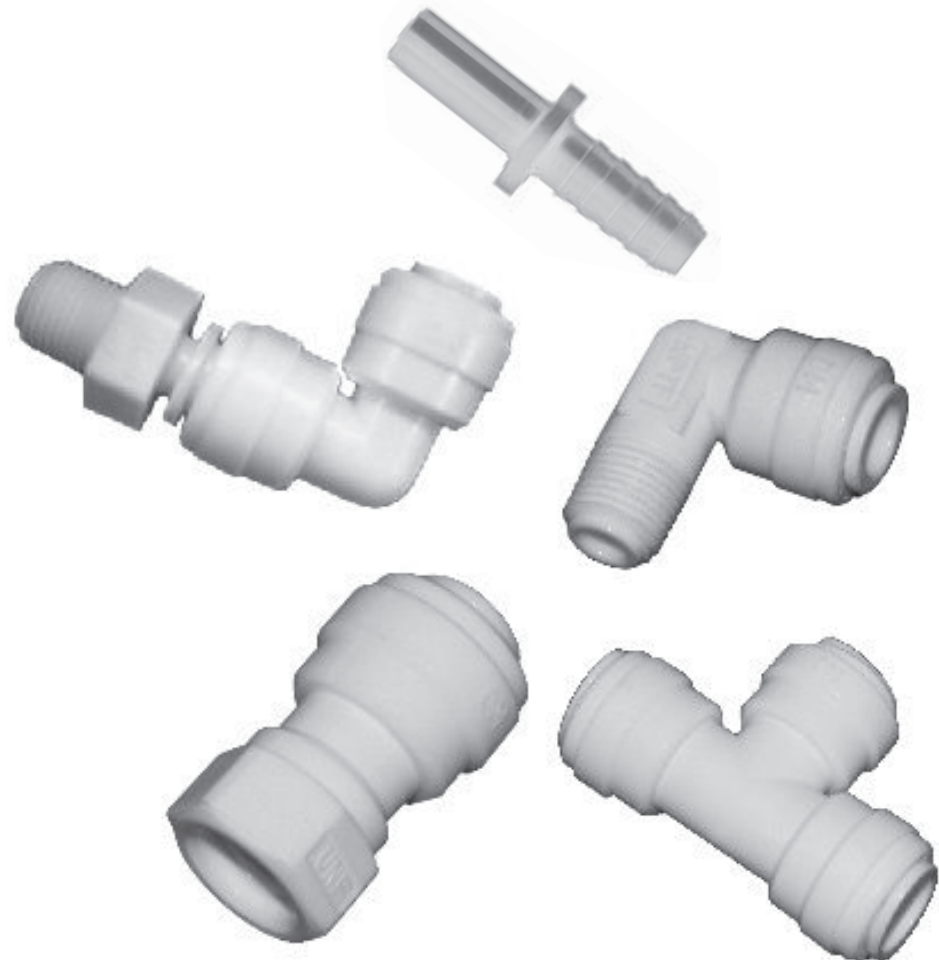

Push-In Tube Fittings

FEATURES

- FDA / NSF compliant
- Quick and easy to use and re-use
- Resists inorganic chemicals, oils, fats, and synthetic detergents

USE WITH (TUBE)

- Polyethylene
- Polyurethane
- Polypropylene
- Nylon

MATERIALS

- Fitting—Acetal copolymer (grey)
- O-ring—Nitrile rubber

APPLICATIONS

- Water conditioning
- Dispensing equipment
- Agricultural
- Industrial & vacuum systems



ADAPTER, FEMALE NPTF THREAD



Tube, OD	Thread, FPT	Mfg. Part No.
1/4"	1/8"	AFA0402
1/4"	1/4"	AFA0404
3/8"	1/4"	AFA0604



CONNECTOR, MALE NPTF THREAD

Tube, OD	Thread, FPT	Mfg. Part No.
1/4"	1/8"	AMC0402
1/4"	1/4"	AMC0404
1/4"	3/8"	AMC0406
3/8"	1/8"	AMC0602
3/8"	1/4"	AMC0604
3/8"	3/8"	AMC0606
3/8"	1/2"	AMC0607
1/2"	3/8"	AMC0706
1/2"	1/2"	AMC0707



CONNECTOR, STRAIGHT



Stem	Barb	Mfg. Part No.
1/4"	1/4"	ATBC0404
3/8"	3/8"	ATBC0606
1/2"	1/2"	ATBC0707



ELBOW, MALE NPTF THREAD



Tube, OD	Thread, FPT	Mfg. Part No.
1/4"	1/8"	AME0402
1/4"	1/4"	AME0404
1/4"	3/8"	AME0406
3/8"	1/4"	AME0604
3/8"	3/8"	AME0606
1/2"	3/8"	AME0706
1/2"	1/2"	AME0707

ELBOW, MALE SWIVEL NPTF THREAD



Tube, OD	Thread, FPT	Mfg. Part No.
1/4"	1/8"	AMES0402
1/4"	1/4"	AMES0404
3/8"	1/4"	AMES0604
3/8"	3/8"	AMES0606
1/2"	3/8"	AMES0706
1/2"	1/2"	AMES0707



ELBOW, UNION



Tube, OD	Tube, OD	Mfg. Part No.
1/4"	1/4"	AEU0404
3/8"	1/4"	AEU0604
3/8"	3/8"	AEU0606
1/2"	3/8"	AEU0706
1/2"	1/2"	AEU0707



UNION CONNECTOR



Tube, OD	Tube, OD	Mfg. Part No.
1/4"	1/4"	AUC0404
3/8"	1/4"	AUC0604
3/8"	3/8"	AUC0606
1/2"	3/8"	AUC0706
1/2"	1/2"	AUC0707



UNION TEE



Tube OD Run	Tube OD Branch	Mfg. Part No.
1/4"	1/4"	ATU040404
3/8"	1/4"	ATU060604
3/8"	3/8"	ATU060606
1/2"	3/8"	ATU070706
1/2"	1/2"	ATU070707



Pressure maximum 170 psi @ 72°F
Temperature range -20°F to 185°F

Additional sizes and configurations, as well as material, including polypropylene, are available contact sales office for more information.

TEE: MALE GARDEN HOSE THREAD x HOSE BARBS

MGHT	HB	MATERIAL	Mfg Part No.	LIST PRICE
3/4"-11-1/2 NH	3/8"	Nylon	TD3438	1.61
3/4"-11-1/2 NH	3/8"	Polypropylene	3-TD3438	1.65
3/4"-11-1/2 NH	1/2"	Nylon	TD3412	1.80
3/4"-11-1/2 NH	1/2"	Polypropylene	3-TD3412	1.70
3/4"-11-1/2 NH	5/8"	Nylon	TD3458	1.70
3/4"-11-1/2 NH	5/8"	Polypropylene	3-TD3458	1.66
3/4"-11-1/2 NH	3/4"	Nylon	TD3434	1.68
3/4"-11-1/2 NH	3/4"	Polypropylene	3-TD3434	1.78

TEE: MALE PIPE THREAD x HOSE BARBS

MPT	HB	MATERIAL	Mfg Part No.	LIST PRICE
1/8"-27 NPT	1/4"	Polypropylene	3-T1814T	0.96
1/4"-18 NPT	1/4"	Nylon	T14T	0.82
1/4"-18 NPT	1/4"	Polypropylene	3-T14T	0.91
1/4"-18 NPT	3/8"	Nylon	T1438T	0.89
1/4"-18 NPT	3/8"	Polypropylene	3-T1438T	0.81
1/4"-18 NPT	1/2"	Nylon	T1412T	0.90
1/4"-18 NPT	1/2"	Polypropylene	3-T1412T	0.83
3/8"-18 NPT	1/4"	Nylon	T3814T	0.80
3/8"-18 NPT	1/4"	Polypropylene	3-T3814T	0.88
3/8"-18 NPT	3/8"	Nylon	T38T	0.87
3/8"-18 NPT	3/8"	Polypropylene	3-T38T	0.83
3/8"-18 NPT	1/2"	Nylon	T3812T	0.93
3/8"-18 NPT	1/2"	Polypropylene	3-T3812T	0.88
1/2"-14 NPT	3/8"	Nylon	T1238T	0.87
1/2"-14 NPT	3/8"	Polypropylene	3-T1238T	0.87
1/2"-14 NPT	1/2"	Nylon	T12T	0.95
1/2"-14 NPT	1/2"	Polypropylene	3-T12T	0.91
1/2"-14 NPT	5/8"	Nylon	T1258T	1.01
1/2"-14 NPT	5/8"	Polypropylene	3-T1258T	0.90
1/2"-14 NPT	3/4"	Nylon	T1234T	1.27
1/2"-14 NPT	3/4"	Polypropylene	3-T1234T	1.09
3/4"-14 NPT	3/8"	Nylon	T3438T	1.42
3/4"-14 NPT	3/8"	Polypropylene	3-T3438T	1.26
3/4"-14 NPT	1/2"	Nylon	T3412T	1.48
3/4"-14 NPT	1/2"	Polypropylene	3-T3412T	1.48
3/4"-14 NPT	5/8"	Nylon	T3458T	1.42
3/4"-14 NPT	5/8"	Polypropylene	3-T3458T	1.26
3/4"-14 NPT	3/4"	Nylon	T34T	1.11
3/4"-14 NPT	3/4"	Polypropylene	3-T34T	1.59

WASHER

OD	ID	MATERIAL	Mfg Part No.	LIST PRICE
1"	11/16"	Vinyl	W406V	0.17

PUSH-IN TUBE FITTINGS

ADAPTER: FEMALE NPTF THREAD

Tube OD	FPT	Mfg Part No.	LIST PRICE
1/4"	1/8"	AFA0402	3.21
1/4"	1/4"	AFA0404	3.21
3/8"	1/4"	AFA0604	4.07

CONNECTOR: MALE NPTF THREAD

Tube OD	MPT	Mfg Part No.	LIST PRICE
1/4"	1/8"	AMC0402	2.14
1/4"	1/4"	AMC0404	2.35
1/4"	3/8"	AMC0406	2.78
3/8"	1/8"	AMC0602	3.00
3/8"	1/4"	AMC0604	3.00
3/8"	3/8"	AMC0606	3.05
3/8"	1/2"	AMC0607	3.16
1/2"	3/8"	AMC0706	3.64
1/2"	1/2"	AMC0707	4.01

CONNECTOR: STRAIGHT

Stem	HB	Mfg Part No.	LIST PRICE
1/4"	1/4"	ATBC0404	1.87
3/8"	3/8"	ATBC0606	2.41
1/2"	1/2"	ATBC0707	2.68

ELBOW: MALE NPTF THREAD

Tube OD	MPT	Mfg Part No.	LIST PRICE
1/4"	1/8"	AME0402	2.73
1/4"	1/4"	AME0404	2.84
1/4"	3/8"	AME0406	3.00
3/8"	1/4"	AME0604	2.84
3/8"	3/8"	AME0606	2.94
1/2"	3/8"	AME0706	3.58
1/2"	1/2"	AME0707	3.75



QUICK COUPLING CONNECTORS

ELBOW: MALE SWIVEL, NPTF THREAD



Tube OD	MPT	Mfg Part No.	LIST PRICE
1/4"	1/8"	AMES0402	4.55
1/4"	1/4"	AMES0404	4.60
3/8"	1/4"	AMES0604	6.37
3/8"	3/8"	AMES0606	6.58
1/2"	3/8"	AMES0706	7.22
1/2"	1/2"	AMES0707	7.33

ELBOW: UNION



Tube OD	Tube OD	Mfg Part No.	LIST PRICE
1/4"	1/4"	AEU0404	3.16
3/8"	1/4"	AEU0604	4.07
3/8"	3/8"	AEU0606	4.07
1/2"	3/8"	AEU0706	4.65
1/2"	1/2"	AEU0707	4.60

UNION CONNECTOR



Tube OD	Tube OD	Mfg Part No.	LIST PRICE
3/8"	1/4"	AUC0604	3.64
3/8"	3/8"	AUC0606	3.64
1/2"	3/8"	AUC0706	4.39
1/2"	1/2"	AUC0707	4.49
1/4"	1/4"	AUC0404	2.68

UNION TEE



OD Run	OD Branch	Mfg Part No.	LIST PRICE
1/4"	1/4"	ATU040404	3.69
3/8"	1/4"	ATU060604	4.60
3/8"	3/8"	ATU060606	4.55
1/2"	3/8"	ATU070706	5.46
1/2"	1/2"	ATU070707	5.19

MALE THREAD SOCKET: 1/4" Flow



CONNECTION SIZE	DESCRIPTION	MATERIAL	Mfg Part No.	LIST PRICE
1/4" MNPT	Non-Valved	Acetal	40AC-S1-04	6.70
3/8" MNPT	Non-Valved	Acetal	40AC-S1-06	6.70
1/4" MNPT	Valved	Acetal	40ACV-SB1-04	7.60
3/8" MNPT	Valved	Acetal	40ACV-SB1-06	7.60
1/4" MNPT	Non-Valved	Acetal	50AC-S1-04	3.23
1/4" MNPT	Valved	Acetal	50ACV-SB1-04	5.32
1/4" MNPT	Non-Valved	Glass-Filled Polypropylene	50GPS1-04	2.85

IN-LINE SOCKET: 1/4" FLOW



CONNECTION SIZE	DESCRIPTION	MATERIAL	Mfg Part No.	LIST PRICE
1/4" PTF	Non-Valved	Acetal	40AC-S9-04	10.31
1/4" HB	Non-Valved	Acetal	40AC-S2-04	5.99
5/16" HB	Non-Valved	Acetal	40AC-S2-05	6.08
3/8" HB	Non-Valved	Acetal	40AC-S2-06	5.99
1/4" PTF	Valved	Acetal	40ACV-SB9-04	12.02
1/4" HB	Valved	Acetal	40ACV-SB2-04	7.41
5/16" HB	Valved	Acetal	40ACV-SB2-05	7.41
3/8" HB	Valved	Acetal	40ACV-SB2-06	7.41
1/4" HB	Non-Valved	Chrome Plated Brass	40CB-S2-04	28.07
5/16" HB	Non-Valved	Chrome Plated Brass	40CB-S2-05	29.02
3/8" HB	Non-Valved	Chrome Plated Brass	40CB-S2-06	28.31
1/4" HB	Valved	Chrome Plated Brass	40CBV-SB2-04	29.74
5/16" HB	Valved	Chrome Plated Brass	40CBV-SB2-05	31.11
3/8" HB	Valved	Chrome Plated Brass	40CBV-SB2-06	29.74
1/4" PTF	Non-Valved	Acetal	50AC-S9-04-LB	10.50
1/4" HB	Non-Valved	Acetal	50AC-S2-04	1.76
1/4" HB	Valved	Acetal	50ACV-SB2-04	6.37
5/16" HB	Valved	Acetal	50ACV-SB2-05	6.37
3/8" HB	Valved	Acetal	50ACV-SB2-06	6.37
1/4" PTF	Valved	Acetal	50ACV-SB9-04	9.83

In-line Socket: 1/4" Flow continued on p.30